

PN 16 Cast Steel Swing Check Valve Stainless Steel Trim

Series 4412 ... Regular

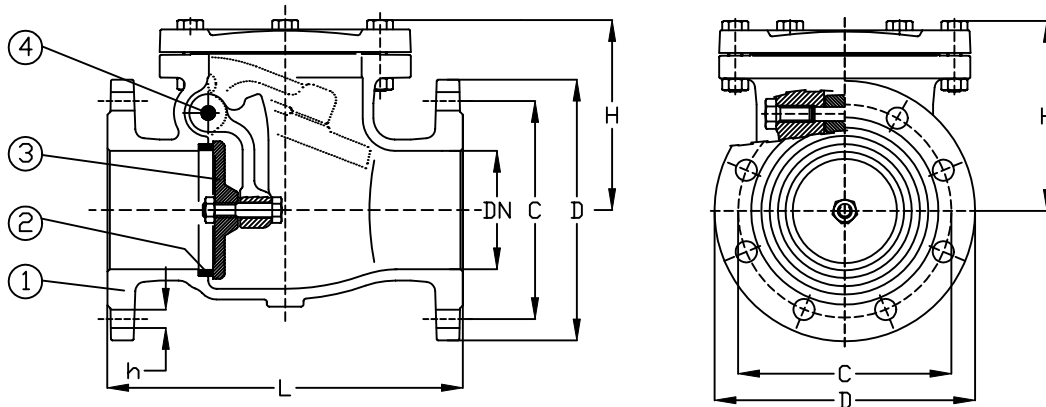

Face to Face according to DIN 3202-F6
Flanges according to DIN2501-PN16

Part Nr.	Material	Code	Size	Nom. Pressure	Hydraulic Inspection	
			DN	PN	Body	Seat
1 - Body	Cast Steel	GSC-25N	40 to 250	16	24	16
2 - Hinge	Stainless Steel	AISI 410				
3 - Disc	Stainless Steel	AISI 410				
4 - Seat	Stainless Steel	AISI 410				

Size	L	D	C	No.	h	t	H	Kg
40	180	150	110	4	18	16	105	12
50	200	165	125	4	18	18	110	14
65	240	185	145	4	18	18	140	19
80	260	200	160	8	18	20	145	23
100	300	220	180	8	18	20	160	35
125	350	250	210	8	18	22	180	43
150	400	285	240	8	22	22	195	67
200	500	340	295	12	22	24	245	99
250	600	405	355	12	26	26	285	149