

PN 16 Swing Check Valves Wafer Style Short

Series 4022 ... Bronze
Series 4052 ... Stainless Steel

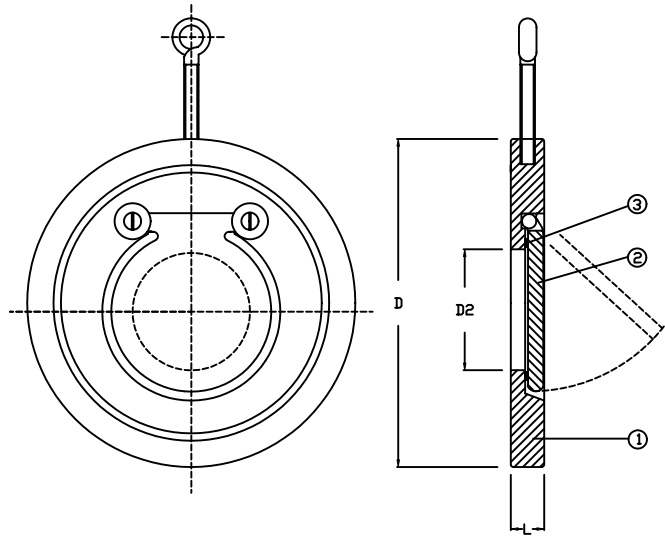

For mounting between flanges according to DIN2501-PN16

Size DN	Nom. Pressure PN	Hydraulic Inspection	
		Body	Seat
40 to 200	16	25	16
250 to 500	10	16	10

Available Material Combinations

Part Nr.	Material	Code
1 - Body	Gunmetal	DIN 1705
	Stainless Steel	AISI 316L
2 - Disc	Gunmetal	DIN 1705
	Stainless Steel	AISI 316L
3 - Seat	NBR	NBR
	EPDM	EPDM
	Viton	FKM
	Teflon	PTFE

Size	L	D	D2	Kg
40	16	94	26	.9
50	19	109	26	.9
65	19	129	38	1.3
80	19	144	47	1.5
100	19	164	70	2
125	19	195	92	3
150	19	221	114	4.8
200	29	276	143	11
250	29	330	190	15
300	38	386	214	25
350	44	446	263	37
400	51	498	305	55
450	60	558	342	65
500	64	620	400	105